

Lina 25™ cable ducting

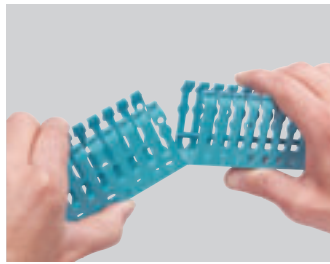

Manually separable trunking

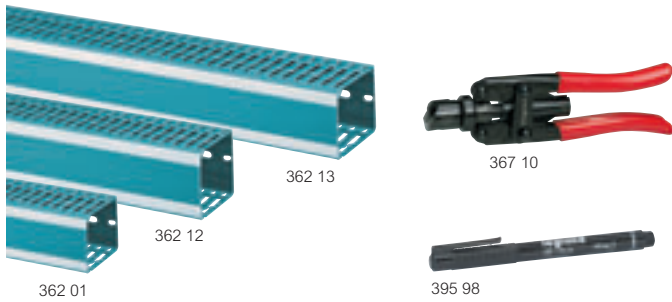
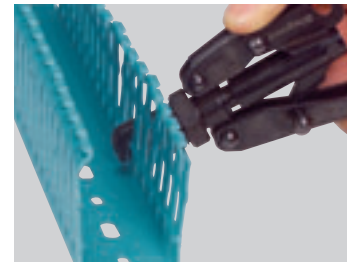

Tabs can be separated using pliers
Cat.No 367 10

Pack	Cat.Nos	Lina 25 ducting	
		RAL 2525 blue PVC, approvals CSA (Canada), UL (USA), conform to EN 50085-2-3 Side perforations at intervals of 12.5 mm Length: 2 m Width x height (mm)	
60 ⁽¹⁾	362 00	25 x 25	
56 ⁽¹⁾	362 01	25 x 40	
56 ⁽¹⁾	362 02	25 x 60	
40 ⁽¹⁾	362 03	25 x 80	
56 ⁽¹⁾	362 05	40 x 25	
48 ⁽¹⁾	362 06	40 x 40	
48 ⁽¹⁾	362 07	40 x 60	
40 ⁽¹⁾	362 08	40 x 80	
32 ⁽¹⁾	362 11	60 x 40	
32 ⁽¹⁾	362 12	60 x 60	
32 ⁽¹⁾	362 13	60 x 80	
24 ⁽¹⁾	362 16	80 x 60	
24 ⁽¹⁾	362 17	80 x 80	
16 ⁽¹⁾	362 25	120 x 80	

Pack	Cat.Nos	Lina 25 cutter tool
1	367 10	For a straight break with fingers

Pack	Cat.Nos	Sleeving	
		Braided sleeving Black polyester Supplied in 25 m roll in dispenser box with an indicator 3 m before end	
		of roll	Ø variations
1	366 38	Ø20 mm	10 to 30 mm
1	366 39	Ø30 mm	18 to 54 mm
		Spiral sleeving	
25	6361 78	12 mm	
25	6361 83	22 mm	

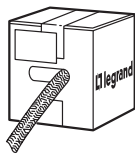

Pack	Cat.Nos	Black felt-tip pen
10	395 98	Indelible for marking

Linifix insulating fixing accessories

Pack	Cat.Nos	Linifix insulating fixing accessories
20	367 00	Material polyamide 6/6 Enable fixing of cable ducting on any support by 1/4 turn On chassis-rail Holds the ducting in place vertically
100	366 40	On rails 15 mm depth 1/4 turn
20	366 41	On Lina 25 perforated plates Clip-on 1/4 turn
20	366 42	On door Fits under control and signalling auxiliaries Osmoz (Ø22) Also enables direct fixing of test-lamps
10	366 43	On Lina 25 uprights Double adjustment to enable alignment with the perforations at the bottom of cable ducting Can be used to fix vertical or horizontal ducting (possible reinforcement with rail , 15 mm depth) To be clipped on
100	366 46	On plain plates plastic rivet length 12 mm for solid plates up to 30 / 10 th Drilling Ø: 5.5 to 6 mm
500	366 44	On plain plates, Lina 12.5 and perforated plates, Lina 25 for cabinets Reinforced plastic rivet Ø 6 mm Drilling Ø: 6 mm
100	347 45	Screw head 4.8 x 16 self-drilling / self-tapping for Ø3.3 mm
200	347 50	Screw cover, for isolating screws head Cat.No 347 45
50	367 01	Cable retainer To clip-on the fingers

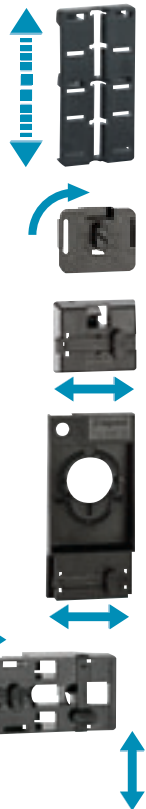

Transcab cable ducting

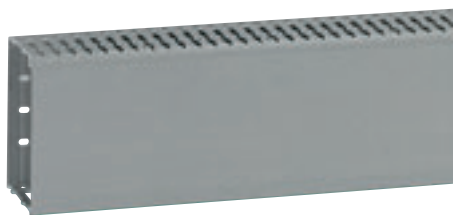

6361 25



6361 17



6362 08



6362 02

6.5 mm wide fingers with a 6 mm spacing
 Accepts up to 6 mm² without breaking side wall finger
 Two pre-scored lines allow removal of fingers 2 m length
 Bump on side wall fingers help cabling
 Rounded fingers prevent injury during cabling
 Conform to EN 500 85 parts 2 and 3
 Approvals:
 CSA (Canada) No 700 861
 UL (USA) No 196 692
 RAL 7030 Grey PVC / RAL 7035 PC ABS halogen free
 Plastic cable ducting (base + cover)

Pack⁽¹⁾ Cat.Nos Plastic cable ducting (base + cover) Grey RAL 7030

Pack ⁽¹⁾	Cat.Nos	Width x Height (mm)	Capacity (mm ²)
32	6360 95	15 x 25	264
60	6361 00	25 x 25	391
56	6361 05	40 x 25	692
40	6360 96	15 x 40	455
56	6361 01	25 x 40	720
48	6361 06	40 x 40	1 245
32	6361 11	60 x 40	1 932
24	6361 15	80 x 40	2 647
24	6361 19	100 x 40	3 363
56	6361 02	25 x 60	1 159
48	6361 07	40 x 60	2 007
32	6361 12	60 x 60	3 115
24	6361 16	80 x 60	4 200
24	6361 20	100 x 60	5 307
16	6361 24	120 x 60	6 403
40	6361 03	25 x 80	1 600
40	6361 08	40 x 80	2 717
32	6361 13	60 x 80	4 216
24	6361 17	80 x 80	5 715
16	6361 21	100 x 80	7 215
16	6361 25	120 x 80	8 729
24	6361 09	40 x 100	3 354
24	6361 14	60 x 100	5 216
20	6361 18	80 x 100	7 078
16	6361 22	100 x 100	8 960
12	6361 23	150 x 100	13 683

Pack Cat.Nos Plastic cable ducting (base + cover) Grey RAL 7035 halogen free

Pack	Cat.Nos	Width x Height (mm)	Capacity (mm ²)
60	6362 00	25 x 25	391
56	6362 01	25 x 40	720
48	6362 06	40 x 40	1 245
56	6362 02	25 x 60	1 159
48	6362 07	40 x 60	2 007
32	6362 12	60 x 60	3 115
40	6362 08	40 x 80	2 717
32	6362 13	60 x 80	4 216
24	6362 17	80 x 80	5 715
16	6362 25	120 x 80	8 729



Accessories

see p. 360

(1) Number of meters contained in each pack

Lina 25™ and Transcab cable ducting

■ Lina 25 installation

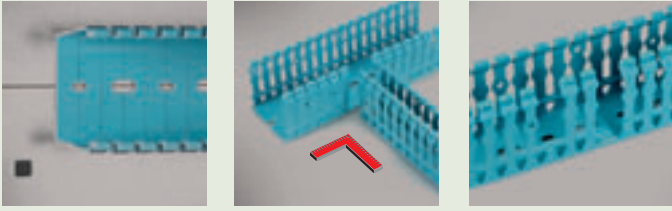

Linear positioning

«T» junction

Cut at two different levels for cable ducting

■ Lina 25 accessories installation

Fixing on rail

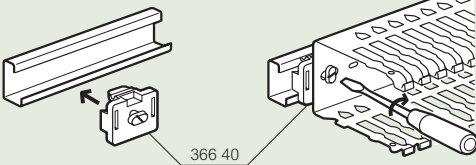

Fixing on perforated plate

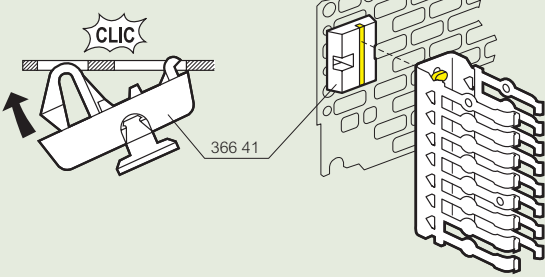

Fixing on door

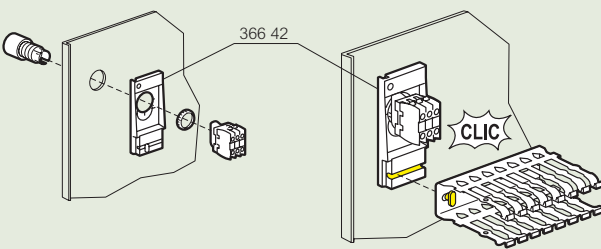

Cable retainer

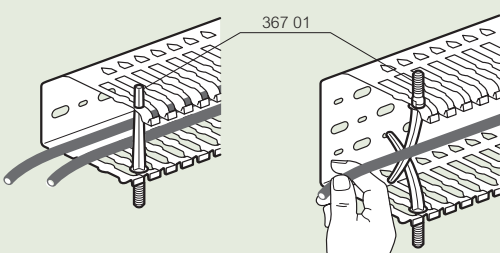

■ Dimensions

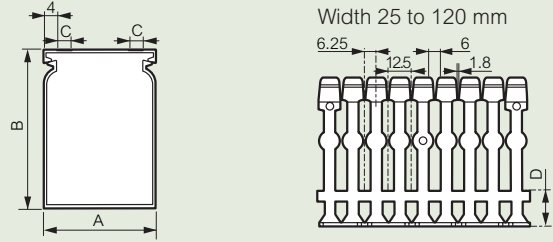

Width 80 to 120 mm

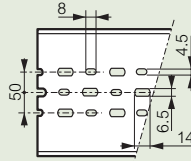

Width 25 to 60 mm

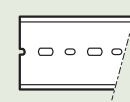

Cat.Nos	A (mm)	B (mm)	C (mm)	D (mm)
362 00 / 6361 00	25	25	6	10.1
362 01 / 6361 01	25	40	5	12.6
362 02 / 6361 02	25	60	6	16.1
362 03 / 6361 03	25	80	6	18.6
362 05 / 6361 05	40	25	10	10.1
362 06 / 6361 06	40	40	10	12.6
362 07 / 6361 07	40	60	10	16.1
362 08 / 6361 08	40	80	10	18.6
362 11 / 6361 11	60	40	10	12.6
362 12 / 6361 12	60	60	10	16.1
362 13 / 6361 13	60	80	10	18.6
362 16 / 6361 16	80	60	10	16.1
362 17 / 6361 17	80	80	10	18.6
362 25 / 6361 25	120	80	10	18.6

Calculating the ducting usable cross-section

Graph for H 05 V-K and H 07 V-K cables with 0.75 packing coefficient

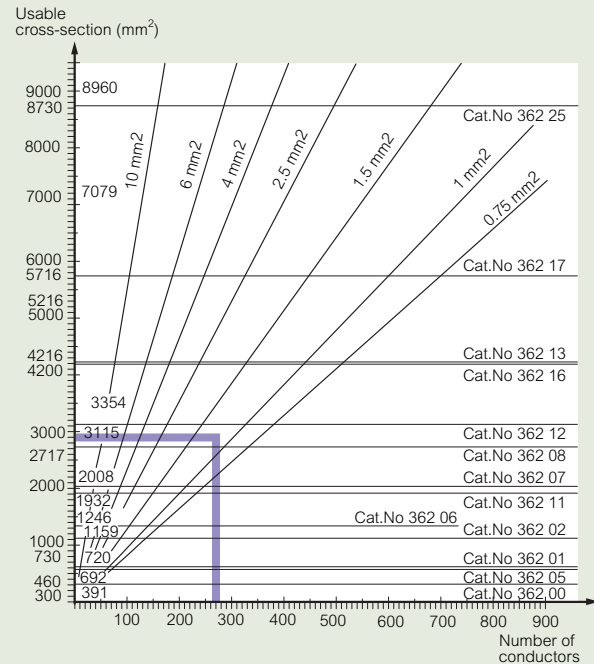

Example :

150 conductors 0.75 mm² → 1230 mm² cross-section and
 120 conductors 1.5 mm² → 1700 mm² cross-section
 Makes a total of 2930 mm²

The correct cable ducting is Cat.No 362 12, 60 x 60,
 with a capacity of 3115 mm²

Colring™ equipment cable ties



320 42 blister packing



320 61/14/31/19/20/49



see p. 906

Technical characteristics (p. 365)
Agreements (p. 906)

For series assembly of electrical cables
With self blocking head and internal teeth
Conform to EN 50146

Pack	Cat.Nos	Colring colourless cable ties			
		Blister packing 100 pcs			
		Except Cat.Nos 320 45 to 320 51: sachet packing 50 pcs			
		Width (mm)	Flat length (mm)	Ø grip capacity (mm)	
				Max.	Min.
1 000/10 000	320 30	2.4	95	18	1.6
1 000/10 000	320 31	2.4	140	33	1.6
1 000/6 000	320 32	2.4	180	46	1.6
1 000	320 37	3.5	140	33	1.6
1 000	320 38	3.5	180	46	1.6
100/2 000	320 39	3.5	280	77	1.6
100	320 40	3.5	360	102	1.6
1 000/4 000	320 42	4.6	180	46	1.6
100/2 000	320 43	4.6	280	77	1.6
100	320 44	4.6	360	102	1.6
100	320 47 ⁽¹⁾	7.6	180	42	4.8
100	320 49 ⁽¹⁾	7.6	360	98	4.8
100	320 50 ⁽¹⁾	7.6	720	218	4.8
100	320 45	7.6	550	166	4.8
100	320 46	9	710	218	14
100	320 48	9	810	246	14
500	320 51	12.6	1030	317	20
		Sachet packing 100 pcs			
		Except Cat.No 318 38: 50 pcs			
2000	318 20	2.4	95	18	1.6
1000	318 21	2.4	140	33	1.6
1000	318 22	2.4	180	46	1.6
1000	318 23	3.5	140	33	1.6
1000	318 24	3.5	180	46	1.6
1000	318 25	3.5	280	77	1.6
1000	318 26	3.5	360	102	1.6
1000	318 27	4.6	180	46	1.6
1000	318 28	4.6	280	77	1.6
1000	318 29	4.6	360	102	1.6
100	318 33	4.6	430	125	1.6
100	318 30	7.6	180	42	4.8
100	318 34	7.6	290	78	4.8
100	318 31	7.6	360	98	4.8
100	318 35	7.6	550	166	4.8
100	318 32 ⁽¹⁾	7.6	720	218	4.8
100	318 36	9	710	218	14
100	318 37	9	810	246	14
500	318 38	12.6	1030	317	20
		Sachet packing 1000 pcs			
1000	318 40	2.4	95	18	1.6
1000	318 41	2.4	140	33	1.6
1000	318 42	2.4	180	46	1.6
1000	318 43	3.5	140	33	1.6
1000	318 44	3.5	180	46	1.6
1000	318 45	3.5	280	77	1.6
1000	318 47	4.6	180	46	1.6
1000	318 48	4.6	280	77	1.6
1000	318 49	4.6	360	102	1.6

Pack	Cat.Nos	Identification colourless cable ties			
		Sachet packing 100 pcs			
		Width (mm)	Flat length (mm)	Ø grip capacity (mm)	
				Max.	Min.
100	320 61 ⁽¹⁾	2.4	95	18	4.0
100	320 63 ⁽¹⁾	4.6	180	46	9.5
		Colring black cable ties			
		High temperature UV protected			
		Blister packing 100 pcs			
		Except Cat.Nos 320 25 to 320 29: Sachet packing (50 pcs for Cat.No 320 28)			
		Width (mm)	Flat length (mm)	Ø grip capacity (mm)	
				Max.	Min.
1000	320 12	2.4	95	18	1.6
1000	320 13	2.4	140	33	1.6
1000	320 14	2.4	180	46	1.6
1000	320 15	3.5	140	33	1.6
1000	320 18	3.5	180	46	1.6
100	320 19	3.5	280	77	1.6
100	320 20	3.5	360	102	1.6
1000	320 22	4.6	180	46	1.6
100	320 23	4.6	280	77	1.6
100	320 24	4.6	360	102	1.6
100	320 29 ⁽¹⁾	7.6	360	98	4.8
100	320 25	7.6	550	166	4.8
100	320 26	9	710	218	14
100	320 27	9	810	246	14
500	320 28	12.6	1030	317	20
		Sachet packing 100 pcs			
		Except Cat.No 318 18: 50 pcs			
2000	318 00	2.4	95	18	1.6
1000	318 01	2.4	140	33	1.6
1000	318 02	2.4	180	46	1.6
1000	318 03	3.5	140	33	1.6
1000	318 04	3.5	180	46	1.6
1000	318 05	3.5	280	77	1.6
1000	318 06	3.5	360	102	1.6
1000	318 07	4.6	180	46	1.6
1000	318 08	4.6	280	77	1.6
1000	318 09	4.6	360	102	1.6
100	318 13	4.6	430	125	1.6
100	318 10	7.6	180	42	4.8
100	318 14	7.6	290	78	4.8
100	318 11	7.6	360	98	4.8
100	318 15	7.6	550	166	4.8
100	318 12 ⁽¹⁾	7.6	720	218	4.8
100	318 16	9	710	218	14
100	318 17	9	810	246	14
500	318 18	12.6	1030	317	20

(1) Non orientated head



Accessories for all the situations

> Fixing



- With self-adhesive base



- With screw mounting base



- With clip-on base

> Marking



- With identification plate

> With Duplix system (see p. 380)

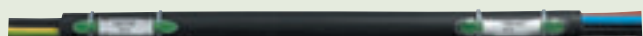

With marker



With label



Pack	Cat.Nos	Colring tool
1	320 88	P. 46 Colring tool for cable ties max. width 4.6 mm Direct adjustment of clamping tension by using the milled screw at the base of handle After clamping, a blade automatically cuts the surplus length close to the head without leaving a burr For cable ties width 7.6 and 9 mm, use Colson tool Cat.No 319 96 (p. 366)

Bases		
Self-adhesive		
100/2000	320 65	Possibility to screw fixing Ø4 mm Colourless - 25 x 30 x 6 mm For cable ties max. width 4.6 mm
100	320 67	Black - 25 x 30 x 6 mm For cable ties max. width 4.6 mm
50	320 68	Black - 38 x 38 x 9.4 mm For cable ties max. width 20 mm
Screw-mounting		
1000	320 70	Colourless For cable ties max. width 4.6 mm 15 x 10 x 6 mm - Screw fixing Ø4 mm
100	320 72	For cable ties max. width 9 mm 21 x 16.5 x 8.8 mm - Screw fixing Ø5 mm
Clip-on		
1000	320 76	For cable ties max. width 4.6 mm For th. 0.5 to 3 mm, drilling Ø6 to 6.5 mm Mounting on Lina 12.5 plates for cabinets and enclosures and on Lina 25 plates for cabinets (p. 280)

Marking accessories		
100	320 85	Colourless identification plate 40 x 22 mm for cable ties max. width 4.6 mm Use felt tip pen Cat.No 395 98 for marking
10	395 98	Black felt tip pen Indelible for marking



Colring™ equipment cable ties

■ Performance

Conform to EN 50146 "cable ties for electrical installations"
UL 1565 approval
Conform to SAE - AS 33671

Ratchet and tensile strength

Colring cable ties		Max. ratchet force (daN)	Min. tensile strength (daN) According to UL 1565 and EN 50146
Black High temperature U.V. protected	Colourless		
318 00 - 320 12	318 40/20 - 320 30	1	8
318 01 - 320 13	318 41/21 - 320 31	1	8
318 02 - 320 14	318 42/22 - 320 32	1	8
318 03 - 320 15	318 43/23 - 320 37	1	13
318 04 - 320 18	318 44/24 - 320 38	1	13
318 05 - 320 19	318 45/25 - 320 39	1	13
318 06 - 320 20	318 26 - 320 40	1	13
318 07 - 320 22	318 47/27 - 320 42	1.5	22
318 08 - 320 23	318 48/28 - 320 43	1.5	22
318 09 - 320 24	318 49/29 - 320 44	1.5	22
318 13	318 33	1.5	22
318 10	318 30 - 320 47	2	53
318 14	318 34	2	53
318 11 - 320 29	318 31 - 320 49	2	53
318 15 - 320 25	318 35 - 320 45	2	53
318 12	318 32 - 320 50	2	53
318 16 - 320 26	318 36 - 320 46	2	77
318 17 - 320 27	318 37 - 320 48	2	77
318 18 - 320 28	318 38 - 320 51	2	111
	320 61	0.5	8
	320 63	0.5	22

Temperature resistance

	Colring colourless	Colring black
- Max. operating temperature	85°C (1000 h at 100°C)	105°C ⁽¹⁾ (1000 h at 120°C)
Min. temperature		
- operating	- 15°C	- 15°C
- installation	- 10°C	0°C

External agents resistance

Good resistance to bases, oils, greases, petroleum products, chlorinated solvents.
Humidity retention: 2.5%

Fire resistance

Flame resistance UL 94: V2
Self extinguishing 850°C acc. to IEC 60695-2-12
Oxygen index: EN ISO 4589-1 / ASTM D 2863-00: 28,5% (26% for Colring black)
Corrosiveness of fumes (NFC 20-453): < 5%
Halogen-free polyamide, class 1 acc. to ASTM D 4066 (Class 2 for Colring black)

■ Dimensions

Identification cable ties

Cat.No 320 61

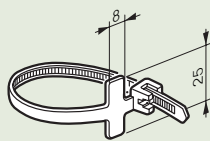

Cat.No 320 63

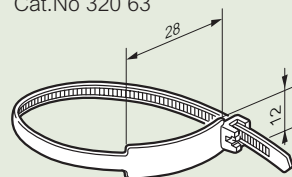

Accessories

Cat.Nos 320 65/67

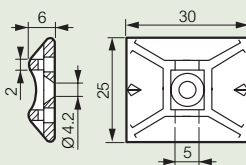

Cat.No 320 70

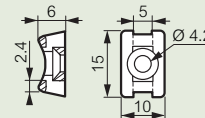

Cat.No 320 72

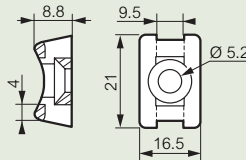

Cat.No 320 76

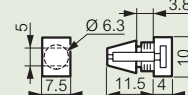

Cat.No 320 85

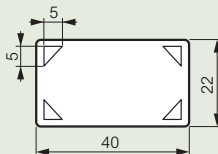

■ Examples of use

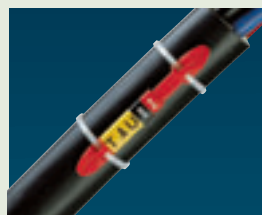

Duplex marker holders Cat.No 384 52, attached using 2 Colring cable ties Cat.No 320 31, equipped with labels

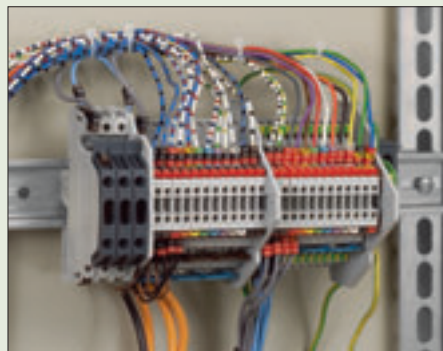

Colring cable ties to maintain cables in an enclosure

(1) Max. operating temperature for Cat.Nos 320 25/26/27/28 and 318 00 to 18: 85°C



Outstanding resistance

> flexibility of the tie



> temporary attachment

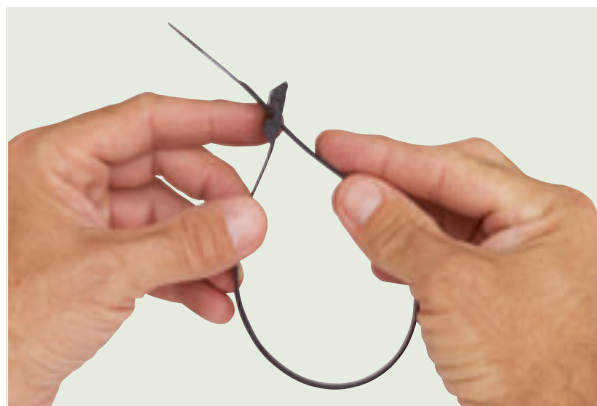

> resistance



To external agents



To rain



To low temperatures



To sunlight

Colson™ installation cable ties



319 16



319 28



see p. 906



319 57



319 96



319 02

Agreements (p. 906)

Pack	Cat.Nos	Black Colson U.V. protected cable ties				
		Conform to EN 50146				
		External teeth				
		Width (mm)	Flat length (mm)	Ø grip capacity (mm)		Tensile Strength (kg)
				max.	min.	
100	319 10	9	123	22	4	36
100/1000	319 13	9	185	42	10	36
100/1000	319 16	9	262	62	26	53
100/1000	319 19	9	357	92	26	53
100/500	319 20	9	498	140	74	53
100	319 21	9	750	220	74	53
100	319 22	6	119	25	4	22
100	319 25	6	180	45	10	22
		Internal teeth				
		Easy manual tightening				
100	319 28	7.6	128	22	8	36
100	319 29	7.6	194	42	15	45
100	319 30	7.6	260	62	15	45
100	319 32	7.6	359	92	15	45

Pack	Cat.Nos	Black U.V. protected bases
100	319 55	Standard plug base Ø8 mm drilling (Ø7 mm smooth material)
100	319 58	Wall spacer plug base Ø8 mm drilling (Ø7 mm smooth material)
100	319 50	Screw-on base, can be fixed with plug Cat.No 319 57 or metal stud Ø7 mm pitch 150 or countersunk screw Ø5 mm

Pack	Cat.Nos	Black U.V. protected screw-in plug
100	319 57	For fixing screw-on base and cable ties with base Ø8 mm drilling (Ø7 mm smooth material) Threaded head Ø6.6 mm pitch 150 Supplied with punch for inserting pin

Pack	Cat.Nos	Black cable tie with U.V. protected base
100	319 02	Internal teeth For cable Ø13 to 38 mm or IRL tube Ø16 to 32 mm Fixing with screw-in plug Cat.No 319 57 or metal stud Ø7 mm pitch 150 or Spit Pulsa staple gun 700 E or Ø5 mm screw

Pack	Cat.Nos	Colson tool
1	319 96	Facilitates tightening and strip cut the nearest of Colson cable ties head

Bases for trunking (p. 708)

Colson™ installation cable ties

■ Performance

Conform to EN 50146 "cable ties for electrical installations"

Test conditions:

- Temperature: 23 °C
- Relative humidity of air: 50 %
- Traction speed: 25.4 mm/min

Ratchet force

Cat.Nos	Max. ratchet force (daN)
319 10	4
319 13	4
319 16	5
319 19	5
319 20	5.5
319 21	5.5
319 22	4
319 25	4
319 28	1.5
319 29	1.5
319 30	1.5
319 32	1.5

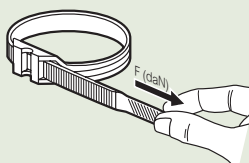

Tensile strength

Cat.Nos	Tensile strength	
	test Ø (mm) according to EN 50146	Min. strength (daN)
319 10	20	36
319 13	20	36
319 16	26	53
319 19	26	53
319 20	74	53
319 21	74	53
319 22	20	22
319 25	20	22
319 28	20	36
319 29	20	45
319 30	20	45
319 32	20	45

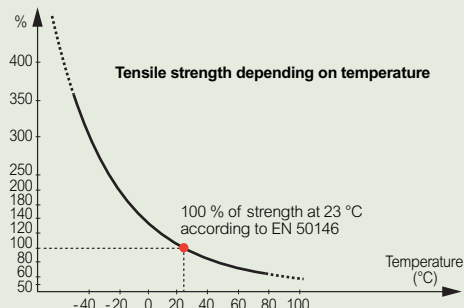

Temperature resistance

Min. temperature:

- operating (permanent use): - 40 °C
- installation: - 30 °C

Max. temperature:

- operating (permanent use): + 85 °C (1 000 h at 100°C)

Resistance to external agents

Good resistance to bases, oils, greases, saline mist, oil products, diluted acids

Humidity absorption ≤ 0,7 % according to ISO 62 (EH O - 23 °C)

Fire resistance

- Flame application time according to EN 50146: 10 s
- Conform to UL 94 requirements, HB classification
- Glow-wire flammability resistance according to IEC 60695-2-11: 650 °C
- Oxygen index (LOI) according to EN ISO 4589-1/ASTM D 2863-00: 20 %
- Corrosiveness of fumes according to NFC 20-453: < 5 %
- Halogen-free polyamide

UV resistance

UV protected black cable ties for outdoor use

Climatic tests according to EDF specification HN 33-S-62 (XPC 20-540)

The black cable ties have successfully undergone climatic ageing tests representing actual conditions of use

These tests combine UV radiation, humidity, water spray, heat and cold
At the end of these tests, the black cable ties retained 80% of their mechanical performance

■ Universal Colson fixing

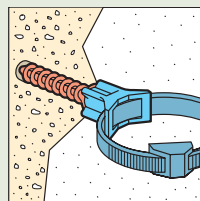

Cat.Nos 319 50 + 319 57

■ Dimensions of accessories

Cat.No 319 55

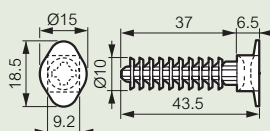

Cat.No 319 58

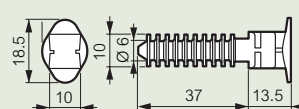

Cat.No 319 50

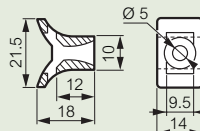

Cat.No 319 57

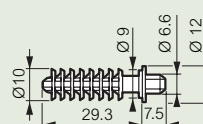

Cat.No 308 81 (p. 708)

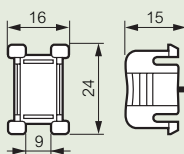

Starfix™ ferrules and crimping tools



Pack	Cat.Nos	Ferrules with insulating flange		
		Provide an equipotential link for all the strands of a flexible conductor Active part in tinned electrolytic copper Conform to NF C 63-023		
		Simple		
		For cables cross-section (mm ²)	Colour	Pack contents
480	376 61	0.5	White	} 12 strips of 40 ferrules
480	376 62	0.75	Blue	
1000	376 63	1	Red	} 25 strips of 40 ferrules
1000	376 64	1.5	Black	
1000	376 66	2.5	Grey	
250	376 67	4	Orange	} 10 strips of 25 ferrules
250	376 68	6	Green	
100	376 69	10	Brown	} Individual
100	376 72 ⁽¹⁾	16	White	
100	376 70	16	White	
50	376 71	25	Black	
50	376 77	35	Red	
30	376 78	50	Blue	
		Double		
		For cables cross-section (mm ²)	Colour	Pack contents
100/500	376 87	2 x 0.75	Blue	} Individual
100/500	376 88	2 x 1	Red	
100/500	376 89	2 x 1.5	Black	
100/500	376 90	2 x 2.5	Grey	

Pack	Cat.Nos	Large capacity Starfix refills		
		Large capacity for less frequent applicator reloading For crimping tools Cat.No 376 49 and 376 91 Active part in tinned electrolytic copper Conform to NF C 63-023 Translucent packaging		
		Cross Section (mm ²)	Colour	Number of ferrules per strip
3 000	376 41	0.5	White	300
3 000	376 42	0.75	Blue	300
3 000	376 43	1	Red	300
3 000	376 44	1.5	Black	300
2 500	376 45	2.5	Grey	250

Pack	Cat.Nos	Crimping tool for strips of ferrules	
		For simultaneously separating and crimping the ferrules of 0.5 to 6 mm ² Crimping operation control system for tools with ratchet Cat.Nos 376 91/96 Supplied complete with colour-coded applicators, for dispensing strips Body: polyetherimide resin Starfix with assisted feed	
		Starfix for 0.5 - 0.75 - 1 - 1.5 and 2.5 mm² cross-sections	
		Supplied with 5 empty applicators	
1	376 49	Standard	
1	376 91	With crimping operation control system for identification by label-holder	
		Starfix for 4 and 6 mm² cross-sections	
		Supplied with 2 empty applicators	
1	376 51	Standard	
1	376 96	With crimping operation control system	
1	376 59	Assorted kit supplied comprising:	
		<ul style="list-style-type: none"> • 1 Starfix tool Cat.No 376 49 with 5 empty applicators • 120 x 0.5 mm² ferrules • 120 x 0.75 mm² ferrules • 240 x 1 mm² ferrules • 320 x 1.5 mm² ferrules • 200 x 2.5 mm² ferrules 	
		Starfix S multi-purpose application tool for 0.5 - 0.75 - 1 - 1.5 and 2.5 mm² cross-sections	
1	376 97	Tool cuts, strips, twists, crimps Supplied complete with 5 empty applicators For left and right-handed persons	

Pack	Cat.Nos	Crimping tool for individual ferrules	
1	376 92	Assorted kit: supplied comprising	
		<ul style="list-style-type: none"> • 1 tool with crimping operation control system for individual ferrules 10 to 50 mm² • 30 individual ferrules 10 mm² • 20 individual ferrules 16 mm² • 15 individual ferrules 25 mm² • 10 individual ferrules 35 mm² • 10 individual ferrules 50 mm² 	

(1) Short ferrule

Starfix™ ferrules and crimping tools

■ Ferrules with insulating flange

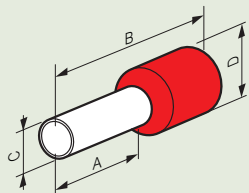

Cat.Nos	Cross-section (mm ²)	A (mm)	B (mm)	C (mm)	D (mm)
376 61	0.5	7.6	14.1	1.5	3.4
376 62	0.75	7.6	14.1	1.5	3.4
376 63	1	7.6	14.1	1.7	3.6
376 64	1.5	7.6	14.1	2	4.1
376 65	2.5	7.6	15.1	2.6	4.8
376 67	4	11.9	21.1	3.2	5.7
376 68	6	11.9	22.9	3.9	7.2
376 69	10	12	21	4.9	8.1
376 72	16	12	23	6.3	9.8
376 70	16	18	29	6.3	9.8
376 71	25	18	31	7.9	12
376 77	35	18	32	8.9	13.5
376 78	50	20	36	11.1	16.1

■ Double ferrules with insulating flange

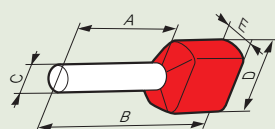

Cross-section (mm ²)	A (mm)	B (mm)	C (mm)	D (mm)
2 x 0.75	8	15	2.1	3.3/6
2 x 1	8	15	2.35	4/6
2 x 1.5	8	16	2.6	4.2/7.2
2 x 2.5	10	18.5	3.3	4.8/8.4

■ Correspondence table

Cross-section (mm ²) Ferrule	Simple ferrule	Large capacity refills
0.5	376 61	376 41
0.75	376 62	376 42
1	376 63	376 43
1.5	376 64	376 44
2.5	376 66	376 45

■ Example of use

Starfix S tool



1 Adjust the cross-section

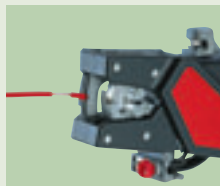

2 Strip and twist

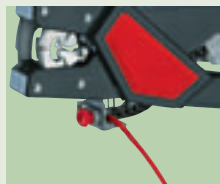

3 Crimp

Tool with ratchet and assisted feed



Wires shaped with simple / double ferrules

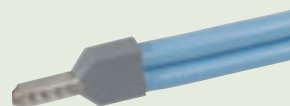

NEW

CAB 3 marking and isolating sleeves

CAB 3 MARKING AND ISOLATING SLEEVES



Tool-free marking and protection...



... before or after connection

A simple, reliable way for colour coding cables and protecting the tubes of lugs

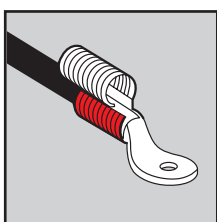

> Time-saving and safety as no tools are needed for fitting or removal either before or after connection

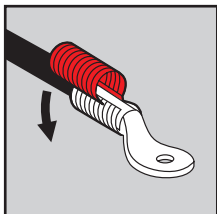

> 5 sizes of sleeve to cover all cable requirements from 10 to 300 mm²

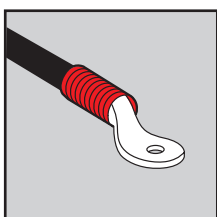

> Increased safety with a perfect hold over time
> Impeccable finish



For colour-marking cables and isolating lug tubes from 10 mm² to 300 mm²
Fitting and removal without tool before or after connection

Pack	Cat.Nos	Sleeves	
Conductor Ø7.1 to 10.5 mm			
		Colour	Length (mm)
100	388 49	blue	20
100	388 50	black	
100	388 51	brown	
100	388 52	red	
100	388 53	yellow	
Conductor Ø10 to 13.5 mm			
		Colour	Length (mm)
50	388 55	blue	29.5
50	388 56	black	
50	388 57	brown	
50	388 58	red	
50	388 59	yellow	
Conductor Ø13 to 17 mm			
		Colour	Length (mm)
25	388 61	blue	38
25	388 62	black	
25	388 63	brown	
25	388 64	red	
25	388 65	yellow	
Conductor Ø16.5 to 23 mm			
		Colour	Length (mm)
20	388 67	blue	46
20	388 68	black	
20	388 69	brown	
20	388 70	red	
20	388 71	yellow	
Conductor Ø22.5 to 29 mm			
		Colour	Length (mm)
10	388 73	blue	55
10	388 74	black	
10	388 75	brown	
10	388 76	red	
10	388 77	yellow	

CAB 3 marking and isolating sleeves

■ Characteristics

Material PA 6.6

Cable cross-section table⁽¹⁾

Cat.Nos	Cross-sections (mm ²)	Ømin. and max.
388 49 to 53	10 to 25	7.1 to 10.5
388 55 to 59	25 to 50	10 to 13.5
388 61 to 65	50 to 95	13 to 17
388 67 to 71	95 to 185	16.5 to 23
388 73 to 77	185 to 300	22.5 to 29



Supplied in dispenser box

■ Dimensions (mm)

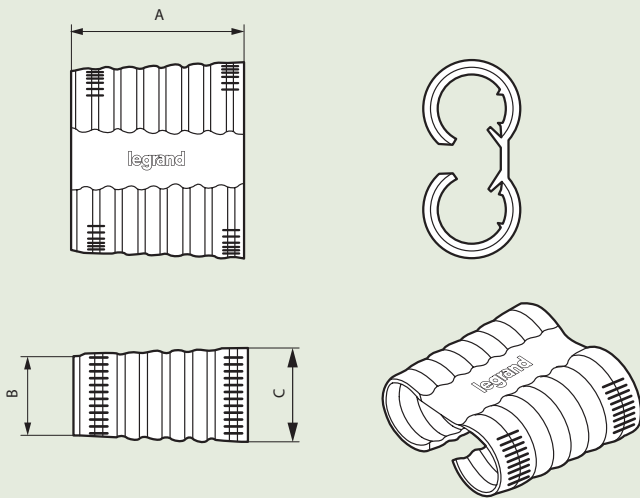

Cat.Nos	A	ØB	ØC
388 49 to 53	20.2	10.9	8.87
388 55 to 59	29.4	14.5	11.57
388 61 to 65	37.9	18.4	14.97
388 67 to 71	46.1	23.3	19.07
388 73 to 77	55.14	30.7	25.51

■ Installation

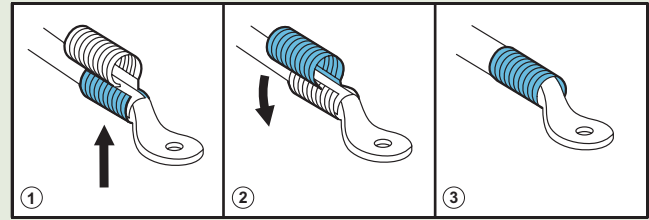

■ Example of use

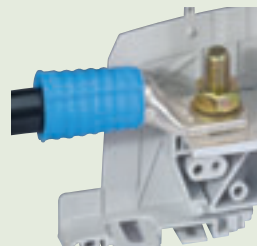

Example of use of sleeve Cat.No 388 61 on a power terminal block



Use of a sleeve on a wired DPX 250



Connection, power devices, etc.

see p. 56 to 108 and p. 358

(1) By way of example, depending on the types of cable end lug

CAB 3™ marking system for wiring and Viking 3 terminal blocks

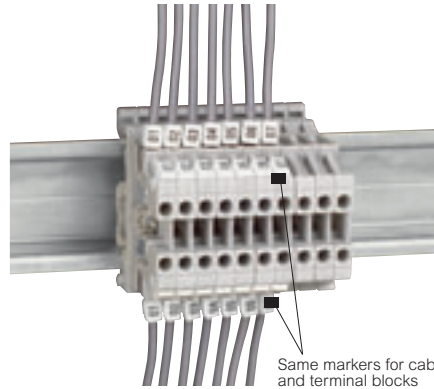

Same markers for cable and terminal blocks

Strips of 20 markers
For marking wiring or Viking 3 terminal blocks

Pack	Cat.Nos	Markers for wiring 0.5 to 1.5 mm ² cross-section and terminal blocks
240	381 50	01 to 20
240	381 51	21 to 40
240	381 52	41 to 60
240	381 53	61 to 80
240	381 54	81 to 100
240	381 55	Blank



Pack	Cat.Nos	Markers for wiring 1.5 to 2.5 mm ² cross-section and terminal blocks
240	381 60	01 to 20
240	381 61	21 to 40
240	381 62	41 to 60
240	381 63	61 to 80
240	381 64	81 to 100
240	381 65	Blank



marking label sheets for Viking 3 terminal blocks

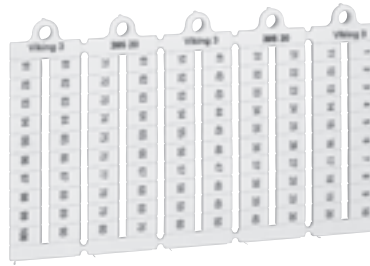

395 20



395 98

Pack	Cat.Nos	Blank markers
1000	395 00	Displayed by sheet of 100 pre-cut markers
1000	395 01	Manual marking or via Logicab 2 (p. 378)
1000	395 02	Pitch (mm)
		5
		6
		8

Pack	Cat.Nos	Numbers Reading of installed marker
		Horizontal format
		Pitch of 5 mm
1000	395 05	From 1 to 10 (10 times)
1000	395 06	From 11 to 20 (10 times)
1000	395 07	From 21 to 30 (10 times)
1000	395 08	From 31 to 40 (10 times)
1000	395 09	From 1 to 50 (2 times)
1000	395 10	From 1 to 100
1000	395 11	From 101 to 200
		Pitch of 6 mm
1000	395 15	From 1 to 10 (10 times)
1000	395 16	From 11 to 20 (10 times)
1000	395 17	From 21 to 30 (10 times)
1000	395 18	From 31 to 40 (10 times)
1000	395 19	From 1 to 50 (2 times)
1000	395 20	From 1 to 100
1000	395 21	From 101 to 200

Pack	Cat.Nos	Black felt tip pen
10	395 98	Indelible for marking

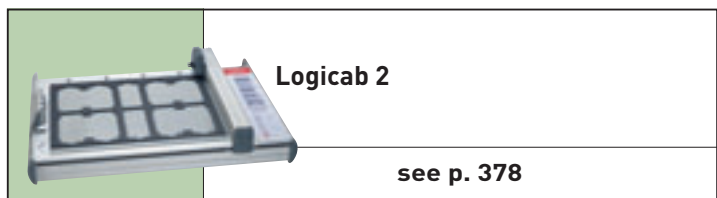

Logicab 2

see p. 378

CAB 3™ marking system for wiring and Viking 3 terminal blocks



Perfect alignment of label holders



382 12

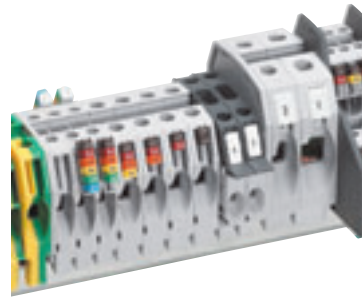

Terminal block with CAB 3 markers and label-holders

Pack ⁽¹⁾	Cat.Nos		
	0.15 to 0.5 ²	0.5 to 1.5 ²	
1000	1200	381 00	382 10
1000	1200	381 01	382 11
1000	1200	381 02	382 12
1000	1200	381 03	382 13
1000	1200	381 04	382 14
1000	1200	381 05	382 15
1000	1200	381 06	382 16
1000	1200	381 07	382 17
1000	1200	381 08	382 18
1000	1200	381 09	382 19
300	381 10	383 00	
300	381 11	383 01	
300	381 12	383 02	
300	381 13	383 03	
300	381 14	383 04	
300	381 15	383 05	
300	381 16	383 06	
300	381 17	383 07	
300	381 18	383 08	
300	381 19	383 09	
300	381 20	383 10	
300	381 21	383 11	
300	381 22	383 12	
300	381 23	383 13	
300	381 24	383 14	
300	381 25	383 15	
300	381 26	383 16	
300	381 27	383 17	
300	381 28	383 18	
300	381 29	383 19	
300	381 30	383 20	
300	381 31	383 21	
300	381 32	383 22	
300	381 33	383 23	
300	381 34	383 24	
300	381 35	383 25	
300	381 40	382 70	
300	381 41	382 71	
300	381 42	382 72	
300	381 43	382 73	
300	381 44	382 74	
300	381 45	382 75	
300	381 46	382 76	

Markers for wiring 0.15 to 0.5 mm² and 0.5 to 1.5 mm² cross-section and terminal blocks

4 markers max. on terminal blocks

Digits: international colour code

- 0 Black
- 1 Brown
- 2 Red
- 3 Orange
- 4 Yellow
- 5 Green
- 6 Blue
- 7 Purple
- 8 Grey
- 9 White



381 06

Letters: black on yellow background

- A
- B
- C
- D
- E
- F
- G
- H
- I
- J
- K
- L
- M
- N
- O
- P
- Q
- R
- S
- T
- U
- V
- W
- X
- Y
- Z



383 17



381 28

Conventional symbols: black on yellow background

- /
-
- +
-
- ~
- ≡
- ±



382 72



381 43

Pack ⁽¹⁾	Cat.Nos		
	1.5 to 2.5 ²	4 to 6 ²	
1200	800	382 20	382 30
1200	800	382 21	382 31
1200	800	382 22	382 32
1200	800	382 23	382 33
1200	800	382 24	382 34
1200	800	382 25	382 35
1200	800	382 26	382 36
1200	800	382 27	382 37
1200	800	382 28	382 38
1200	800	382 29	382 39
300	383 30	383 60	
300	383 31	383 61	
300	383 32	383 62	
300	383 33	383 63	
300	383 34	383 64	
300	383 35	383 65	
300	383 36	383 66	
300	383 37	383 67	
300	383 38	383 68	
300	383 39	383 69	
300	383 40	383 70	
300	383 41	383 71	
300	383 42	383 72	
300	383 43	383 73	
300	383 44	383 74	
300	383 45	383 75	
300	383 46	383 76	
300	383 47	383 77	
300	383 48	383 78	
300	383 49	383 79	
300	383 50	383 80	
300	383 51	383 81	
300	383 52	383 82	
300	383 53	383 83	
300	383 54	383 84	
300	383 55	383 85	
300	382 80	382 90	
300	382 81	382 91	
300	382 82	382 92	
300	382 83	382 93	
300	382 84	382 94	
300	382 85	382 95	
300	382 86	382 96	

Markers for wiring 1.5 to 2.5 mm² and 4 to 6 mm² cross-section

Digits: international colour code

- 0 Black
- 1 Brown
- 2 Red
- 3 Orange
- 4 Yellow
- 5 Green
- 6 Blue
- 7 Purple
- 8 Grey
- 9 White



382 32



382 26

Letters: black on yellow background

- A
- B
- C
- D
- E
- F
- G
- H
- I
- J
- K
- L
- M
- N
- O
- P
- Q
- R
- S
- T
- U
- V
- W
- X
- Y
- Z



383 46



383 79

Conventional symbols: black on yellow background

- /
-
- +
-
- ~
- ≡
- ±



(1) Up to 0.5 mm²: strips of 25 markers
From 0.5 mm² to 2.5 mm²: strips of 30 markers
Upper 2.5 mm²: strips of 20 markers
Price per marker

CAB 3™ marking system accessories



384 90



384 92



383 92 + markers
CAB 3



382 05

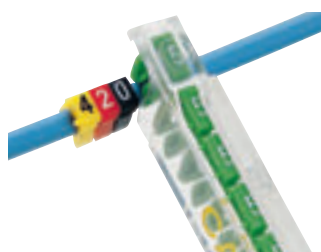

383 97



382 00

Pack	Cat.Nos	Accessories CAB 3
		Marker-holders For cables cross-section from 10 mm ² to 70 mm ² Capacity: 8 digits, letters or symbols markers from 0.5 to 1.5 mm ² or 1.5 to 2.5 mm ² cross section Black, cross-section (mm ²)
100	384 90	10 to 16
50	384 91	25 to 35
50	384 92	50 to 70
		Support for markers Can be clipped on Viking 3 terminal blocks Capacity: 7 markers from 0.15 to 0.5 mm ² 6 markers from 0.5 to 1.5 mm ²
100	383 92	
		Installation tool
1	382 05	Kit: 1 tool + 3 heads Make it easier to install CAB 3 markers (0.15 to 0.5 mm ² and 0.5 à 1.5 mm ²) on Viking 3 terminal blocks
20	382 06	Replacement head for installation tool Cat.No. 382 05
		Transparent applicators For rapid selection and application of markers onto cable
		For markers cross-section (mm ²) Applicator colour for identification of cross-section
10	383 94	0.15 to 0.5 CAB 3
10	383 95	0.5 to 1.5 CAB 3
10	383 96	1.5 to 2.5 CAB 3
10	383 97	4 to 6 CAB 3

Pack	Cat.Nos	Accessories CAB 3 (continued)
		Set of markers
1	382 01	0.15 to 0.5 mm ² : 2 500 markers + 10 applicators (250 digits from 0 to 9)
1	382 02	0.5 to 1.5 mm ² : 3 000 markers + 10 applicators (300 digits from 0 to 9)
1	382 03	1.5 to 2.5 mm ² : 3 000 markers + 10 applicators (300 digits from 0 to 9)
1	382 04	4 to 6 mm ² : 2 000 markers + 10 applicators (200 digits from 0 to 9)
		On-site toolbox With removable tray for CAB 3 markers and applicators, Starfix ferrules... Height 85 mm, depth 280 mm, width 450 mm Metal, padlockable
1	382 00	

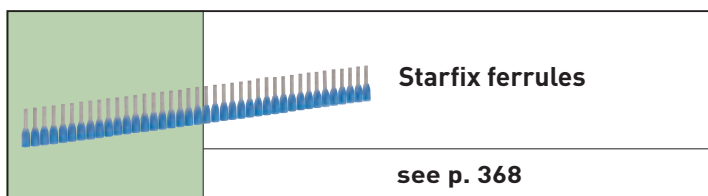

CAB 3™ marking system

for wiring and Viking 3 terminal blocks

■ Dimensions

Markers

Polyamide 6/6

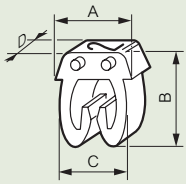

Dimensions	Cable cross-section (mm²)			
	0.15 to 0.5	0.5 to 1.5	1.5 to 2.5	4 to 6
A (mm)	5	5	5.6	8
B (mm)	5.05	6.4	7.6	9.6
C (mm)	3.7	4.3	4.9	7.1
D (mm)	2.3	3	3	3
Ø mini/maxi (mm)	0.8/2.2	2.2/3	2.8/3.8	4.3/5.3

Cat.Nos 381 50 to 381 55 et 381 60 to 381 65: no liking stud.
D = 6 mm

Marker holders

Cat.No. 384 90

Cat.No. 384 91

Cat.No. 384 92

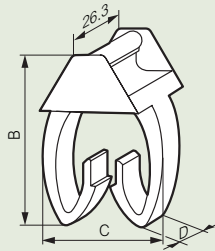
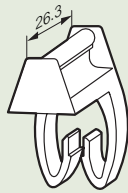

Dim.	Section of cable for marking (mm²)		
	10 to 16	25 to 35	50 to 70
A (mm)	18	24.3	27.2
B (mm)	8.9	12.2	17.2
C (mm)	7	7	10

Support for markers Cat.No 383 92

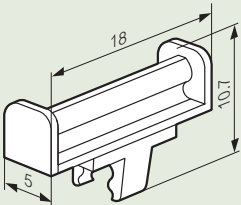

■ Characteristics and dimensions of on-site toolbox

Cat.No 382 00

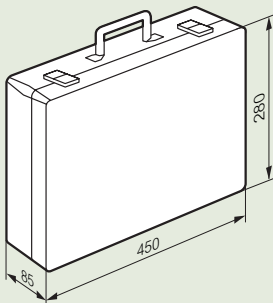

- Bottom tray consists of:
- 8 medium slots (each slot takes 1 box of CAB 3)
 - 1 large slot
- Top tray consists of:
- 12 small slots (<=> approx. 6 boxes of CAB 3)
 - 1 medium slot for applicators
- Capacity: approx. 15000 CAB 3 markers

■ CAB 3 installation tool Cat.No 382 05



Installation of CAB 3 markers or Viking 3 terminal blocks.

■ Example of CAB 3 marking

On cable with marker-holder Cat.No 384 91

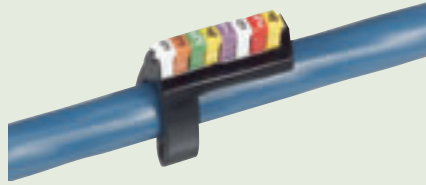

On cable with marker-holder Cat.No 384 92



On terminal blocks with marker-holder Cat.No 383 92

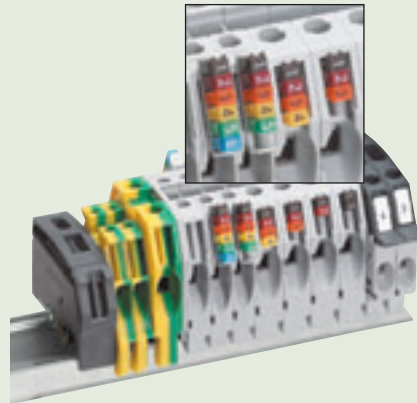

On power terminal blocks

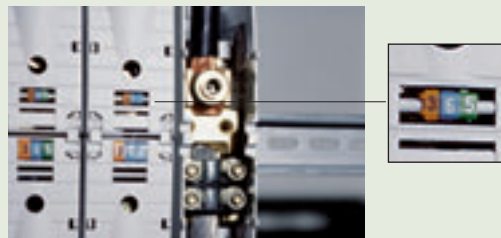

Memocab™ marking system for wiring



Marking system with closed ring
High resistance in very aggressive environments

Pack ⁽¹⁾	Cat.Nos	Marker-holders for wiring			
Length of marking: 12 mm (4 markers)					
		Section (mm ²)		ø (mm)	
		min.	max.	min.	max.
1000	379 27	0.25	1.5	1.3	3.5
1000	379 28	0.75	4	2.3	4.8
Length of marking: 15 mm (6 markers)					
1000	379 30	0.25	1.5	1.3	3.5
1000	379 31	0.75	4	2.3	4.8
500	379 32	4	16	4.2	7.6
Length of marking: 18 mm (7 markers)					
1000	379 36	0.25	1.5	1.3	3.5
1000	379 37	0.75	4	2.3	4.8
500	379 38	4	16	4.2	7.6
500	379 33	16	50	7.6	12.5
200	379 34	50	95	12.5	19
100	379 35	95	300	19	29.5
Length of marking: 30 mm (12 markers)					
500	379 40	0.25	1.5	1.3	3.5
500	379 41	0.75	4	2.3	4.8
200	379 42	4	16	4.2	7.6
200	379 43	16	50	7.6	12.5
Length 500 mm (to be cut)					
10	379 44	0.75	4	2.3	4

Pack ⁽¹⁾	Cat.Nos	Marker-holders for simultaneous marking of both ends			
Pre-cut label holders in rolls					
Length of marking: 18 mm (7 markers)					
1000	379 20	0.25	1.5	1.3	3.5
1000	379 21	0.75	4	2.3	4.8
500	379 22	4	16	4.2	7.6

Pack ⁽¹⁾	Cat.Nos	Marker-holders for cables			
Length of marking: 20 mm (8 markers)					
100	377 12	Fixing with Colring cable ties			

Pack ⁽¹⁾	Cat.Nos	Marker-holders for all devices			
Length of marking: 17.5 mm (7 markers)					
100	377 10	Adhesive			

Pack	Cat.Nos	Accessories	
1	379 91	Double dispenser board	For 48 strips of markers (supplied empty)
		Selecting prong	For selecting the markers and placing them in the label holder
10	379 90	For 30 mm marker holders	
10	379 92	For 15 mm marker holders	
10	379 89	Double for 30 or 18 mm marker holders (for simultaneous marking of both ends)	
		Extractor	For 15 mm marker holders
10	379 93		

Marking kit, consult us

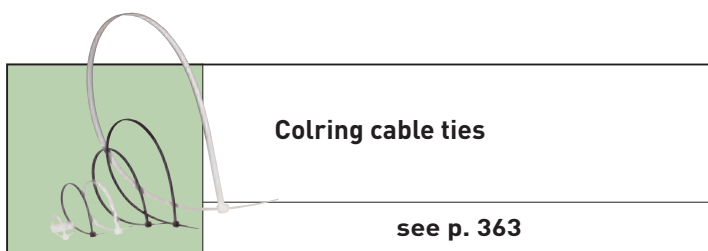

(1) Pre-pack: see Cat.Nos index

Memocab™ marking system for wiring (continued)



378 01 to 378 10



378 05 + 2 x 378 06 + 378 01
+ 378 10 + 378 09 + 378 08
in a label holder Cat.No 379 38

Pack ⁽¹⁾	Cat.Nos	Markers
---------------------	---------	---------

Numbers on colour background

Black or white marking
(international colour code)

600	378 01	Purple	7
600	378 02	Orange	3
600	378 03	White	9
600	378 04	Grey	8
600	378 05	Green	5
600	378 06	Yellow	4
600	378 07	Brown	1
600	378 08	Blue	6
600	378 09	Black	0
600	378 10	Red	2



378 06

Numbers on white background

Black marking

600	377 80	0
600	377 81	1
600	377 82	2
600	377 83	3
600	377 84	4
600	377 85	5
600	377 86	6
600	377 87	7
600	377 88	8
600	377 89	9



377 85

Capital letters

Black marking on white background

240	378 26	A
240	378 27	B
240	378 28	C
240	378 29	D
240	378 30	E
240	378 31	F
240	378 32	G
240	378 33	H
240	378 34	I
240	378 35	J
240	378 36	K
240	378 37	L
240	378 38	M
240	378 39	N
240	378 40	O
240	378 41	P
240	378 42	Q
240	378 43	R
240	378 44	S
240	378 45	T
240	378 46	U
240	378 47	V
240	378 48	W
240	378 49	X
240	378 50	Y
240	378 51	Z



378 30

Conventional symbols

Black marking on white background

240	379 54	/
240	379 55	•
240	379 56	+
240	379 57	-
240	379 58	~
240	379 59	≡
240	379 60	⊥



379 56

Memocab™ marking system for wiring

Installation

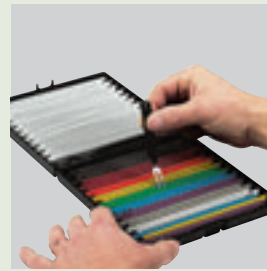

1 Simultaneous marking of both ends

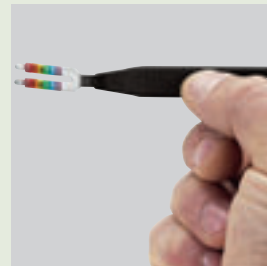

2 Use of double selecting prong



3 Installation in double marker-holder

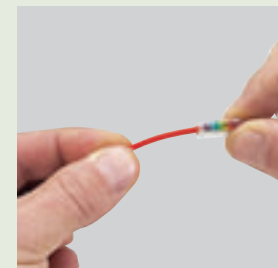
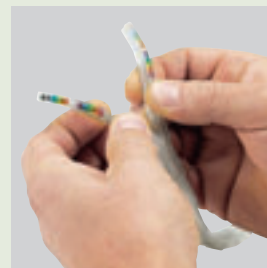

The double strip can be used on site, where each marker-holders of both side will be placed on conductors

(1) Packing of 600 markers comprising 25 strips of 24 markers
Packing of 240 markers comprising 10 strips of 24 markers
Price per marker

NEW

Logicab™ 2 universal marking system

for Memocab, Duplix, adhesive markers, control and signalling devices, terminal blocks

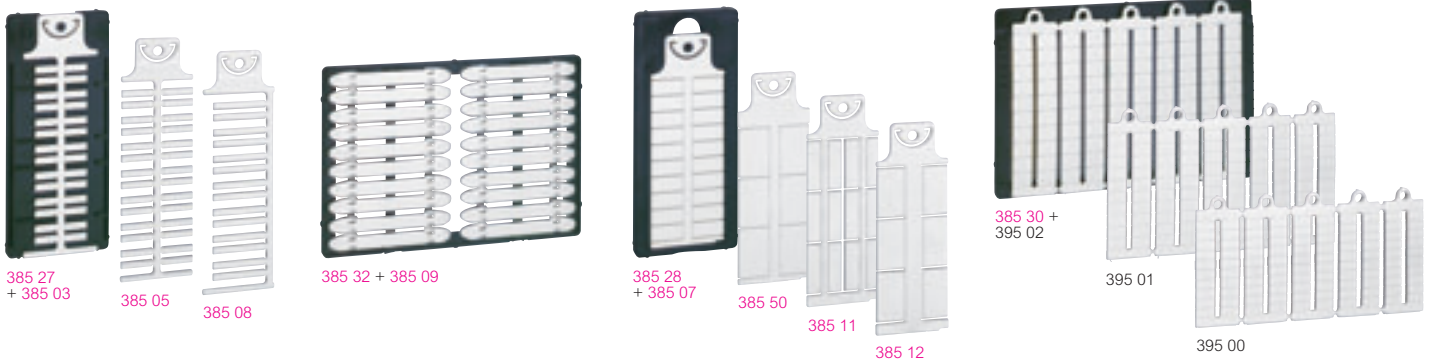
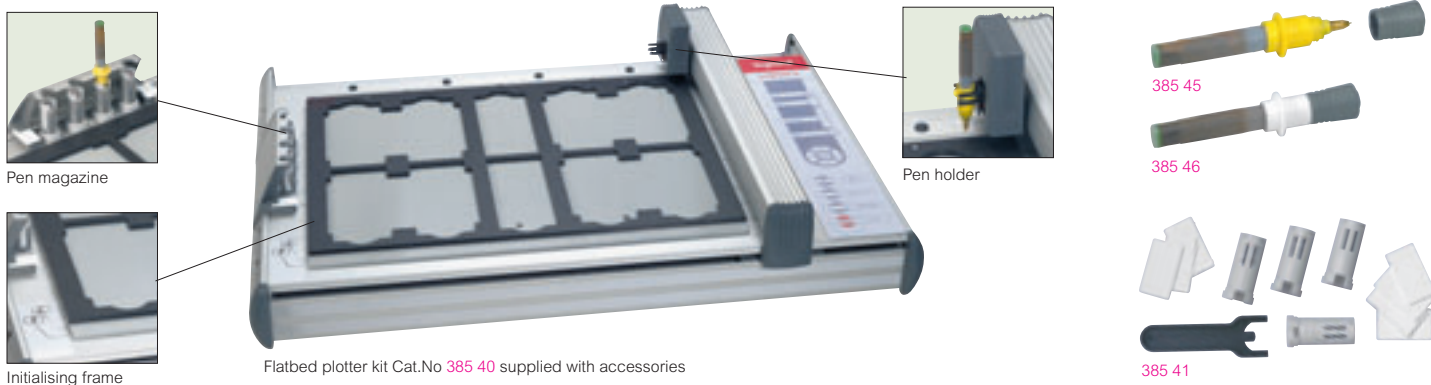

For editing and printing markings on a flatbed plotter to identify equipment components: devices, wiring, terminal strips, cables, adhesive labels

Pack	Cat.Nos	Flatbed plotter kit
1	385 40	Composition: - 1 program compatible with Windows 2000 / XP - 1 A3 flatbed plotter for marking blank markers - 1 positioning frame taking the various marker sheet supports - 4 sheet supports (385 27/28/30/32) - 1 set of markers - 1 disposable pen Ø0.35 mm - 1 PC/plotter link cord - 1 power supply 100 - 240 V ~ 50/60 Hz / 24 V= 1.4 A maxi - 1 protection cover

Pack	Cat.Nos	Marking equipment
1/5	385 45	Disposable black pen Ø0.25 mm Ø0.35 mm
1/5	385 46	
1	385 38	Cleaning solvent Bottle 30 ml
5	385 41	Plotter maintenance kit Composed of 4 pen holders for magazine, 1 releasing key and initialising frame

Pack	Cat.Nos	Marker sheet supports
5	385 27	For installing on the positioning frame of the flatbed plotter kit, Cat.No 385 40 Take the various blank markers For Memocab markers For Duplix markers For adhesive markers and control and signalling devices
4	385 32	
5	385 28	
4	385 30	For Viking 3 markers Cat.Nos 395 00/01/02 For competitor terminal markers, Cat.Nos 385 64/65/66/67
4	385 31	

Pack	Cat.Nos	Blank markers								
840	385 03	Memocab - for wiring and all device types For use together with Memocab marker-holders <table border="1"> <thead> <tr> <th>Max. no. of characters</th> <th>No. of markers / sheet</th> </tr> </thead> <tbody> <tr> <td>4 (11.5 x 4 mm)</td> <td>28</td> </tr> <tr> <td>8 (17.5 x 4 mm)</td> <td>28</td> </tr> <tr> <td>16 (29 x 4 mm)</td> <td>14</td> </tr> </tbody> </table>	Max. no. of characters	No. of markers / sheet	4 (11.5 x 4 mm)	28	8 (17.5 x 4 mm)	28	16 (29 x 4 mm)	14
Max. no. of characters	No. of markers / sheet									
4 (11.5 x 4 mm)	28									
8 (17.5 x 4 mm)	28									
16 (29 x 4 mm)	14									
840	385 05									
420	385 08									
100	385 09	Duplix - for cables 2 white markers Fixing by Colring tie, width 2.4 or 3.5 mm UV protection with cover, Cat.No 384 97 (p. 380)								
800	385 07	White adhesives for all device types Optimum holding of support on plastics and lacquered sheet 17.5 x 8 mm 26 x 17 mm								
240	385 50									
1 000	395 00	For Viking 3 terminal blocks Also mount on MPCBs (p. 137) Available in sheets of 100 markers For blocks 5 mm pitch For blocks 6 mm pitch For blocks 8 mm pitch								
1 000	395 01									
1 000	395 02									
1 000	385 64	For competitors blocks Entrelec / Wago / Phoenix - Pitch 5 Entrelec / Wago / Phoenix - Pitch 6 Weidmüller - Pitch 5 Weidmüller - Pitch 6								
1 000	385 65									
1 000	385 66									
1 000	385 67									
480	385 11	For control and signalling devices Marker 8 x 27 mm For use with marker-holder, Cat.No 385 16								
192	385 16	Marker-holder 8 x 27 mm Transparent cover for marker, Cat.No 385 11								
192	385 14									
240	385 12	Marker 15 x 27 mm For use with marker-holder, Cat.No 385 17								
192	385 17	Marker-holder 15 x 27 mm Cover for marker, Cat.No 385 12								
192	385 15									

Bold pack quantities: Minimum quantities to be ordered
 Red catalogue numbers: New products

Logicab™ 2 universal marking system

for Memocab, Duplix, adhesive markers, control and signalling devices and terminal blocks

Logicab 2 universal marking system for all electrical installations: Memocab and Duplix wire and cable markers, markers for wiring devices, control and signalling devices, terminal blocks

■ Design

Software

For PC equipped with Intel Pentium II processor (or equivalent) or higher, running Windows 2000 or XP, 128 MB RAM (512 MB recommended)

- Input of labels on markers and display of the result
- Option to create markers automatically, to sort and organise them
- Recovery of data directly from diagram software without re-inputting (import of any ASCII mode file or files from IGE-XAO software in FNR(1) mode)

■ Print

Marking with flatbed plotter

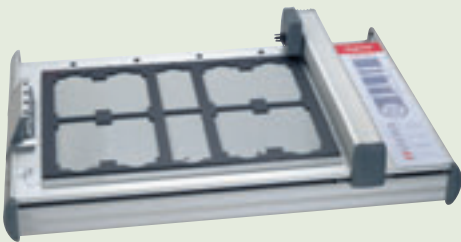

- Work area 305 x 440 mm
- Max print speed 40 cm/s
- Power supply via separate mains adapter
- Parallel port
- USB 1.1 port
- Storage magazine for 4 pens
- Pen initialising zone

Installation of marker supports

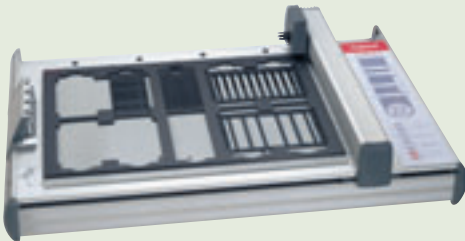

Marker positioning

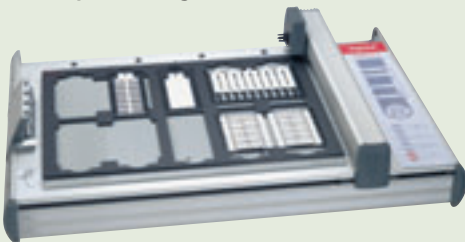

One or several types of markers possible on the same tray

■ Mark

Wiring marker

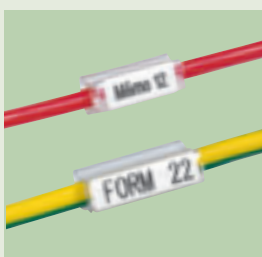

For use with Memocab marker-holders, length 12, 18, 30 mm (p. 376)

Duplix type cable marker

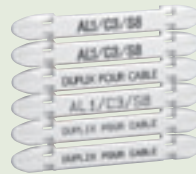

Attached by Colring tie, width 2.4 or 3.5 (p. 363)

Wiring device marker

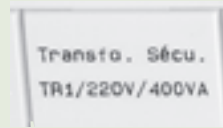

Adhesive markers (17.5 x 8 or 26 x 17 mm) for all device types

Control and signalling device marker



For use with universal marker-holders, diameter 22.5 and covers (8 x 27 or 15 x 27 mm)

Terminal block marker

Viking 3 terminal block markers, pitch 5, 6 and 8



Markers for other terminal blocks, pitch 5 and 6

Entrelec, Wago, Weidmüller, Phoenix

Marking equipment



Pens with no risk of smears
Double seal caps to prevent the ink drying out
Industrial quality ink

Duplix™ marking system for cables



Cat.No 384 52 with label and label-holder Cat.No 384 98



Cat.No 384 56 with marker and protective cover Cat.No 384 97



Opened marking system with marker-holders Cat.No 384 55

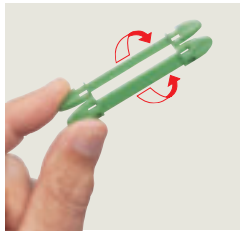

Clip-on marking system

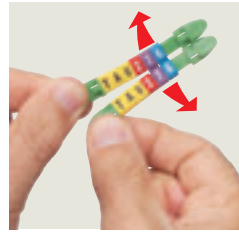
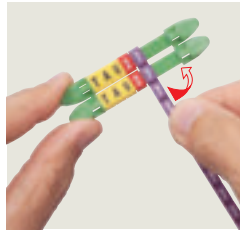
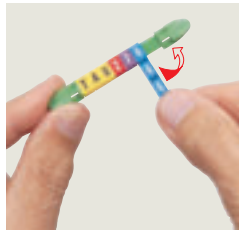

Opened or closed marking system, with markers or labels

Pack ⁽¹⁾	Cat.Nos		Marker-holders
	7 markers	14 markers	Fitted using Colring 2.4 and 3.5 mm cable ties
100	384 50	384 60	● Black
100	384 52	384 62	● Red
100	384 54	384 64	● Yellow
100	384 55	384 65	● Green
100	384 56	384 66	● Blue

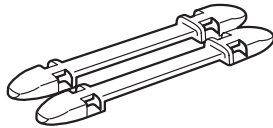

Pack ⁽¹⁾	Cat.Nos	Markers
800	384 00	Numbers: Black or white marking on colour background (international colour code)
800	384 01	0 Black
800	384 02	1 Brown
800	384 03	2 Red
800	384 04	3 Orange
800	384 05	4 Yellow
800	384 06	5 Green
800	384 07	6 Blue
800	384 08	7 Purple
800	384 09	8 Grey
800	384 09	9 White
600	384 10	Letters: Black on yellow background
600	384 11	A
600	384 12	B
600	384 13	C
600	384 14	D
600	384 15	E
600	384 16	F
600	384 17	G
600	384 18	H
600	384 19	I
600	384 20	J
600	384 21	K
600	384 22	L
600	384 23	M
600	384 24	N
600	384 25	O
600	384 26	P
600	384 27	Q
600	384 28	R
600	384 29	S
600	384 30	T
600	384 31	U
600	384 32	V
600	384 33	W
600	384 34	X
600	384 35	Y
600	384 35	Z

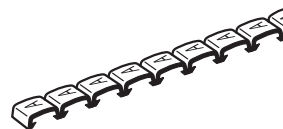

Pack	Cat.Nos	Markers (continued)
600	384 40	Conventional symbols: Black on a yellow background
600	384 41	/
600	384 42	•
600	384 43	+
600	384 44	-
600	384 45	~
600	384 46	≡
600	384 99	⊥
600	384 99	Blank
1	384 96	Set of Duplix markers 100 digits from 0 to 9

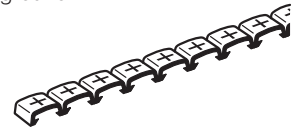

Pack	Cat.Nos	Accessories
100	384 98	Label-holder for 7 markers Clips onto marker-holders Duplix or on end cap Cat.No 394 00 Holds and protects labels 9 mm wide printed using title printer Cat.No 385 85 on tape Cat.No 385 81 (p. 379)
100	384 97	UV protective cover Enables closed cable marking system Clips onto label-holders for 7 markers
1	382 00	On-site toolbox With removable tray for CAB 3 markers and applicators, Starfix ferrules... Height 85 mm, depth 280 mm, width 450 mm Metal, padlockable

labelling system



385 85



Tapes for hand-held printer



Heat-shrinkable sleeves
385 70/71/72/73

For making identification labels for patch panels, cables and wiring accessories
Labels on adhesive tape
Numerous print functions and settings, data memorisation and import possible

Pack	Cat.Nos	Portable labelling system
1	385 85	Supplied complete in carrying case with hand-held printer power supply unit 200-240 V~ 50/60 Hz, 9 volts 2 tape cassettes, Cat.Nos 385 82/87 serial link cable for PC, software on CD for importing data onto memory card, 64 Ko memory card Operates with 6 LR6 batteries (not supplied) or rechargeable battery Cat.No 385 99 (not supplied) or power supply unit (supplied)
1	385 98	64 Kb memory card for saving data
1	385 99	Rechargeable battery pack

Tapes for hand-held printer

Permanent polyester for wiring accessory faceplates

Indoor or outdoor use
Length 5.5 m x width:
9 mm

1	385 81	White	Metal grey
1	385 82	385 84	
1	385 83	385 86	

Flexible polyamide for curved surface cables
Indoor use

Length 3.5 m x width:
12 mm
19 mm

1	385 87	White	Yellow
1	385 88	385 89	385 90

Flexible vinyl for cords or faceplates
Indoor or outdoor use

Length 5.5 m x width:
12 mm

1	385 95	White	Yellow
1	385 92	Orange	Green
1	385 91	Red	

19 mm
Transparent polyester
9 mm width, 7 mm length

1 385 96
Non adhesive 12 mm width, 5.5 mm length

Heat-shrinkable sleeves

Length (mm)	Width (mm)	Conductor Ø (mm)		Colour		
		Min.	Max.			
1	385 70	1.5	6	1.18	2.33	White
1	385 71	1.5	9	1.73	3.73	White
1	385 72	1.5	12	2.97	5.13	White
1	385 73	1.5	19	4.64	8.70	White

Accessories for Cat.No 049 50

Tape refill (black characters on white background)
9 mm width
5 049 53
5 049 54
12 mm width

labelling system

Technical characteristics

- Thermal transfer printing
- Integrated cutter
- 1 to 4 lines of print (width 19 mm)
- Variety of styles and fonts: boxed, bold, underlined, etc
- Justification of text
- Standard electrical symbols or via 64 Kb card
- Barcode option, 6 formats
- Memorisation of 8 commonly used labels or 4 typical print settings
- Copy and incrementation function
- Automatic stop

Memorisation of labels on 64 Kb card

Enables specific cards to be created for a workshop, a project, etc.
Data or files imported from txt format applications, or data entry via keypad

Import software supplied on CD-ROM

Import possible from diagram software in ASCII, Excel® or Word® format

Compatible with Windows® 95/98/2000/ME/NT

Labelling methods



Lexic: per module or on faceplate per row (polyester)



Terminal blocks: horizontal or vertical marking

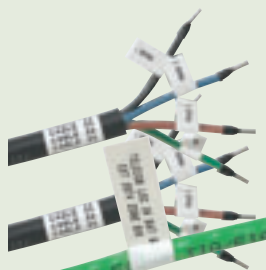

Cables: projecting or rolled round vertical or horizontal (flexible polyamide)



Switchgear adjustable length according to label-holder